

qPublic.net™ Hardin County, KY PVA

Summary

Parcel Number 118-40-06-025
Location Address 306 BROWN ST
Property Class Residential
Tax District 06
Acres 0.154
Description (Note: Not to be used on legal documents)
Subdivision
Deed Book/ Deed Page WILL 12-576
Deed Date

[View Map](#)



Valuation

	2023	2022	2021	2020
Residential Land Value	\$9,700	\$9,700	\$8,500	\$8,500
+ Residential Improvement Value	\$101,400	\$101,400	\$79,400	\$79,400
= Residential Total Value	\$111,100	\$111,100	\$87,900	\$87,900
- Homestead Exemption	(\$46,350)	\$0	\$0	\$0
- Disability Exemption	\$0	\$0	\$0	\$0
= Taxable Assessment Total	\$64,750	\$111,100	\$87,900	\$87,900

Owner

SHEPARD ROBERT G
 306 BROWN ST
 VINE GROVE KY 40175-0000

Improvement Information

Description		Finished Basement %	0
Type of Residence	2-STORY	Bedrooms	4
Year Built	1941	Full Baths	1
Num Stories	2	Half Baths	0
Above Ground Sqft	1904	Exterior	ALUM/VINYL
Total Living Area	1904	Heat	GAS
Basement	FULL	Air Condition	CENTRAL/AC
Basement Sqft	840	Fireplace	1
Basement Sqft Finish	0		

Recent Sales In Area

Sale date range:

From:

01/19/2020

To:

01/19/2023

Sales by Area

1500

Feet



Sales by Distance

Photos



Sketches

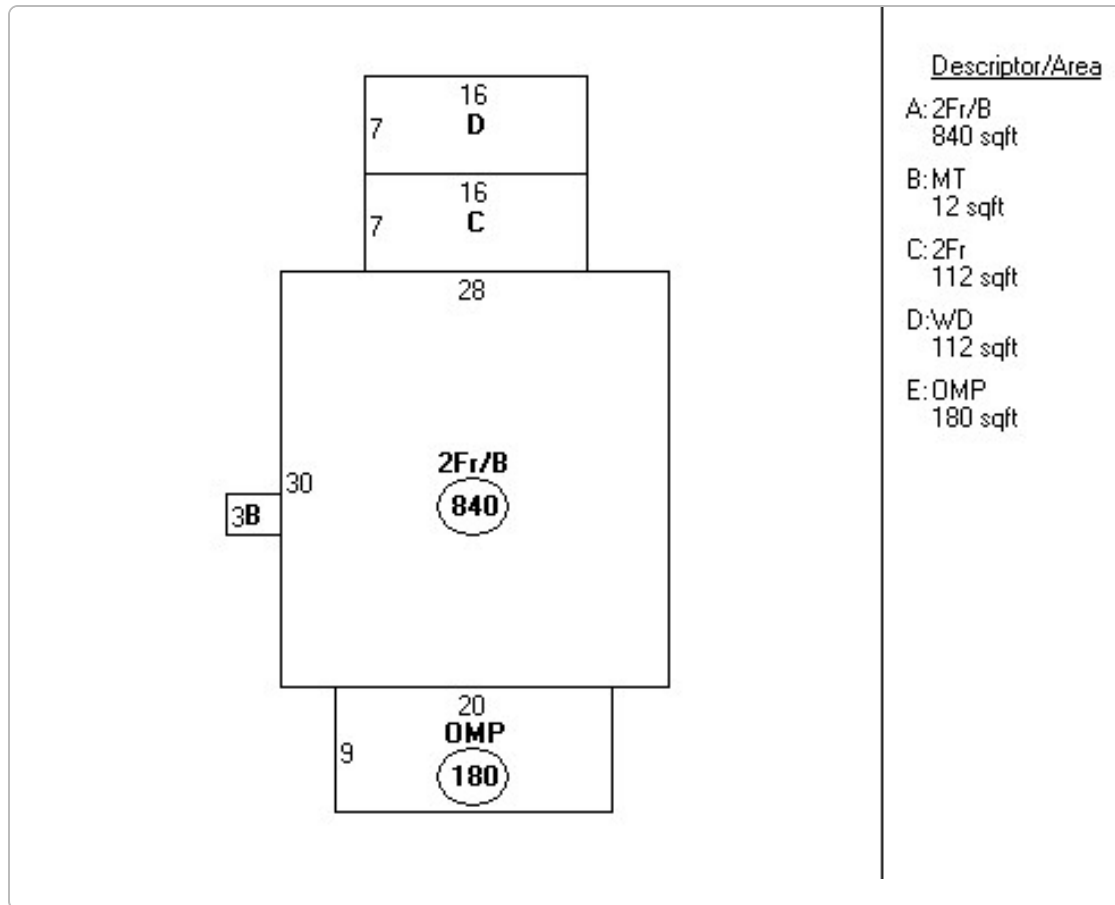

No data available for the following modules: Outbuildings, Sales.

Hardin County makes every effort to produce the most accurate information possible. No warranties, expressed or implied, are provided for the data herein, its use or interpretation.

[User Privacy Policy](#)
[GDPR Privacy Notice](#)

Last Data Upload: 1/18/2023, 5:53:28 PM

Developed by
 Schneider
GEOSPATIAL

Version 2.3.241